

REVISIONS

LTR	ECN NO.	DESCRIPTION	APP'D.	DATE
A	B208	RELEASED TO PRODUCTION	JM	12/98

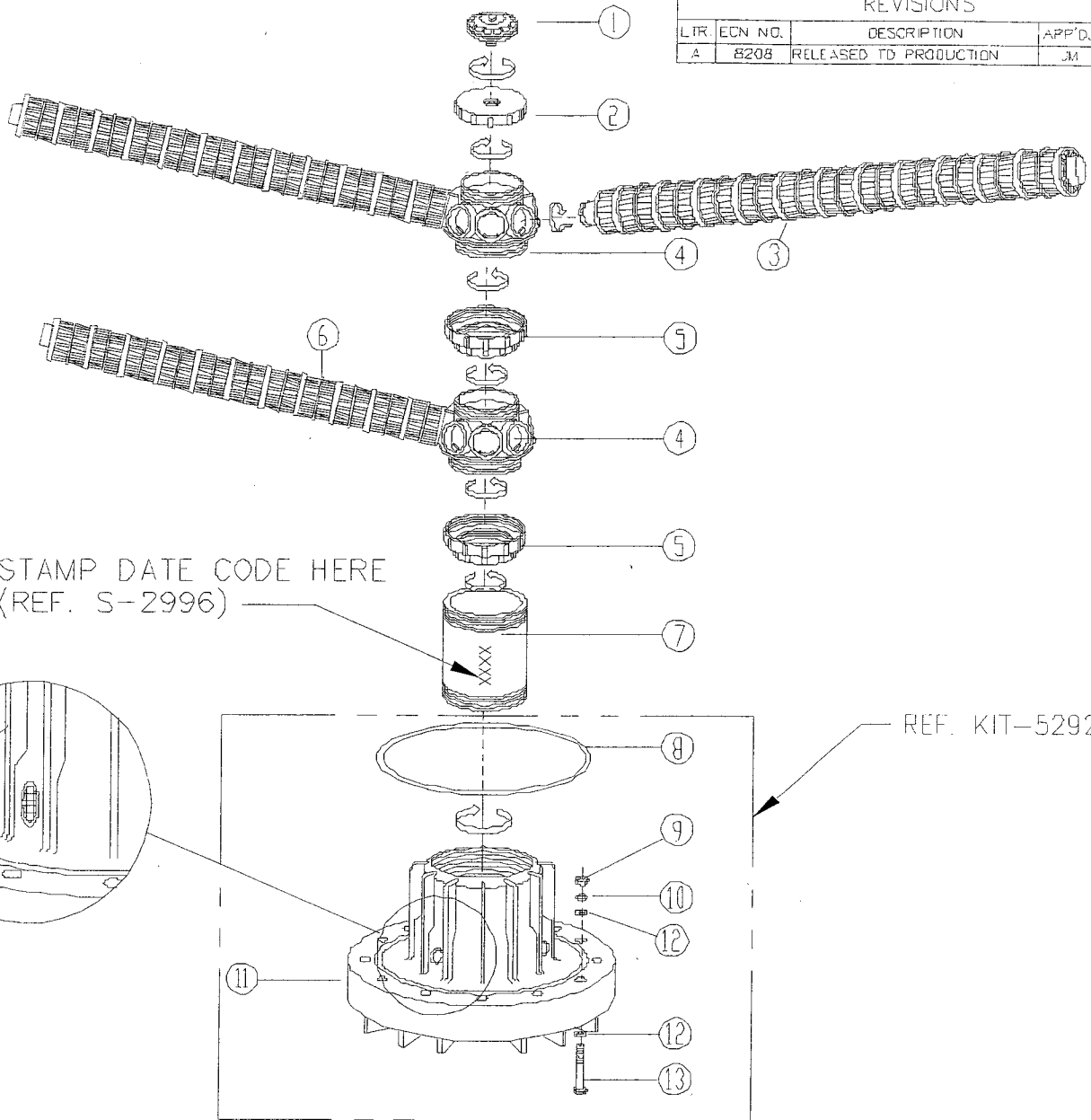

15	1	2218-1&2	CARTON TOP & BOTTOM OF SINGLE 10x10x29 TELESCOPE
14	1	5857	INSTRUCTIONS
13	12	4750-1	BOLT
12	24	4750-4	WASHER
11	1	4735-25	ADAPTER
10	12	4750-3	WASHER
9	12	4750-2	NUT
8	1	2694-69	O-RING
7	1	5063	PIPE (CPVC)
6	8	13493	LATERAL - 24.0" LENGTH
5	2	5730	ADAPTER
4	2	5724	HUB (ABS)
3	8	5493	LATERAL - 26.4" LENGTH
2	1	5733	ADAPTER
1	1	5732	CAP LATERAL
ITEM	QTY	PART NO	NAME and DESCRIPTION
BILL OF MATERIALS			

STRUCTURAL			INDUSTRIAL PKWY	
NORTH AMERICA			110 PARK DRIVE	An ESSEF Company
			CHARDON, OHIO	
TITLE				
BOTTOM MOUNT HUB & LATERAL SYSTEM ASSEMBLY - HIGH FLOW - 6" FLANGE for 63" DIA. COMPOSITE FLANGED TANK				
DRAWN	CS	12/11/98	DWG SIZE	SCALE
CHECKED			A	NONE
PROJ ENG	JM		DRAWING NUMBER	DWS. REV.
DIR of ENG	JM	12/11/98	14248	A
			SHEET	1 OF 1